



The Stapleton

A contemporary 3 bedroom home



The Stapleton

Plots 20 & 21

915 sq.ft/85.00 sq.m

Ground Floor

Hall	1.62m x 1.92m	5'3" x 6'3"
Living room	4.59m (3.87m*) x 3.94m	15'0" (12'8"*) x 12'11"
Kitchen/Dining room	4.53m x 3.51m	14'10" x 11'6"
WC	0.98m x 1.78m	3'2" x 5'10"

First Floor

Master Bedroom	3.36m x 2.91m	11'0" x 9'6"
Ensuite	2.22m x 1.50m	7'3" x 4'11"
Bedroom 2	2.87m x 4.16m	9'5" x 13'7"
Bedroom 3	2.62m x 2.68m	8'7" x 8'9"
Bathroom	2.17m x 1.90m	7'1" x 6'2"

*Maximum dimensions supplied for irregular shaped rooms

Floor Plans & Dimensions We have provided floor plans to show the approximate dimensions of the properties on this site. The dimensions may vary as each property is built individually and precise internal finishes may vary during the course of construction. External finishes will vary from plot to plot. Some plots may be handed versions of the illustrations (mirror image) and may be detached, semi-detached or terraced.

Elevations and Internal Finishes Artist impressions/CGI's have been used to represent the houses to be built. The colours and finish of the various external elevations may vary from house to house. The area surrounding each property may also differ from that shown. Please be sure to check with our sales representative for details of the finishes relating to your chosen property at the time of reservation.

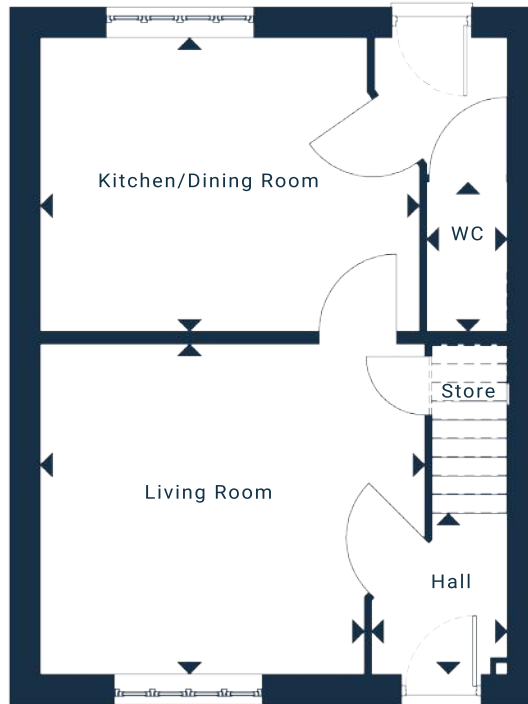

Ground Floor

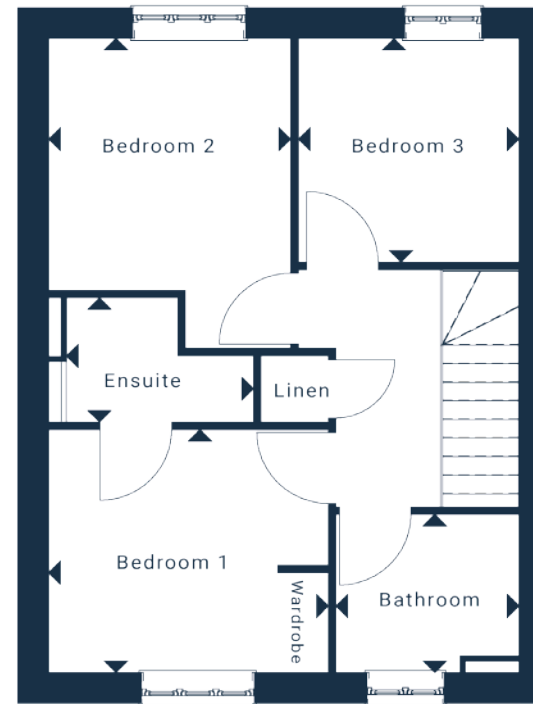

First Floor