

# The Holcombe



Plot 16

**760 sq.ft/70.60 sq.m**

\*Maximum dimensions supplied in irregular shaped rooms.

## Ground Floor

**Garage** 3.0m x 6.0m  
9'10" x 19'8"

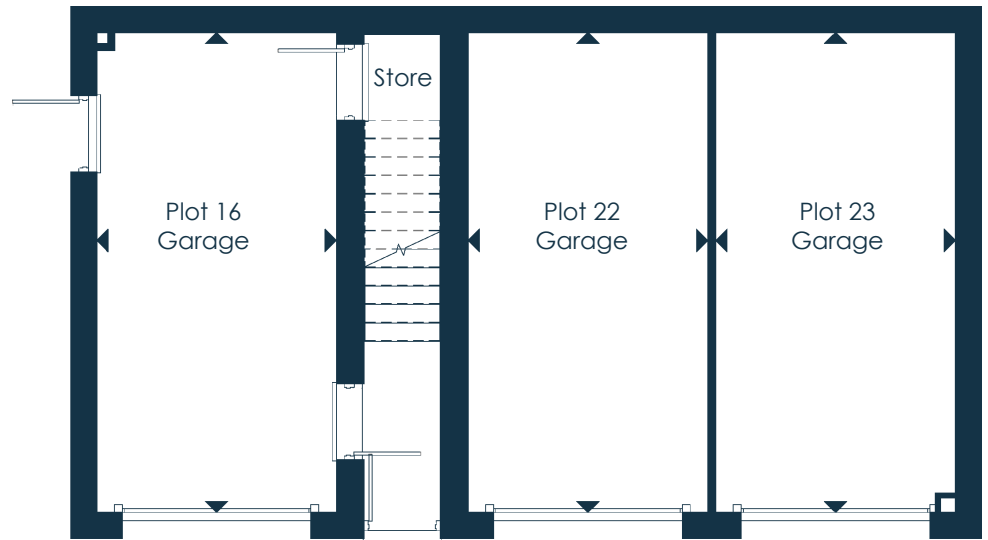

## First Floor



<b>Living/Dining room</b>	3.7m (4.1m*) x 2.95m 12'1" (13'5"*) x 9'8"
<b>Kitchen</b>	3.7m x 3.0m 12'1" x 9'10"
<b>Master Bedroom</b>	3.22m (4.28m*) x 3.83m 10'6" (14'0"*) x 12'6"
<b>Bedroom 2</b>	2.51m x 3.83m 8'2" x 12'6"
<b>Bathroom</b>	1.9m x 2.02m 6'2" x 6'7"



**Floor Plans & Dimensions** We have provided floor plans to show the approximate dimensions of the properties on this site. The dimensions may vary as each property is built individually and precise internal finishes may vary during the course of construction. External finishes will vary from plot to plot. Some plots may be handed versions of the illustrations (mirror image) and may be detached, semi-detached or terraced.

**Elevations and Internal Finishes** Artist impressions/CGI's have been used to represent the houses to be built. The colours and finish of the various external elevations may vary from house to house. The area surrounding each property may also differ from that shown. Please be sure to check with our Sales representative for details of the finishes relating to your chosen property at the time of reservation.