

The Preston

Plot 2

Ground Floor

Entrance Hall	1.09m(1.95m*) x 5.29m	3'6" (6'4"*) x 17'4"
Living Room	3.33m x 5.29m	10'11" x 17'4"
Kitchen	3.74m x 3.41m	12'3" x 11'2"
Family Room	4.38m x 3.41m	14'4" x 11'2"
Dining Room/Study	2.66m x 3.34m	8'8" x 10'11"
Utility	1.68m x 1.86m	5'6" x 6'1"
Cloakroom	0.9m x 1.86m	2'11" x 6'1"

*Maximum dimensions supplied in irregular shaped rooms

First Floor

Bedroom 1	3.33m x 3.97m	10'11" x 13'0"
Ensuite	1.48m x 2.06m	4'10" x 6'9"
Bedroom 2	3.13m(3.67m*) x 3.97m	10'3" (12'0"*) x 13'0"
Ensuite	2.59m x 1.48m	8'6" x 4'10"
Bedroom 3	2.18m(3.42m*) x 2.8m(4.09m*)	7'1" (11'2"*) x 9'2" (13'5"*)
Bedroom 4	2.59m x 3.2m	8'6" x 10'6"
Bathroom	1.94m x 1.99m(2.8m*)	6'4" x 6'6" (9'2"*)

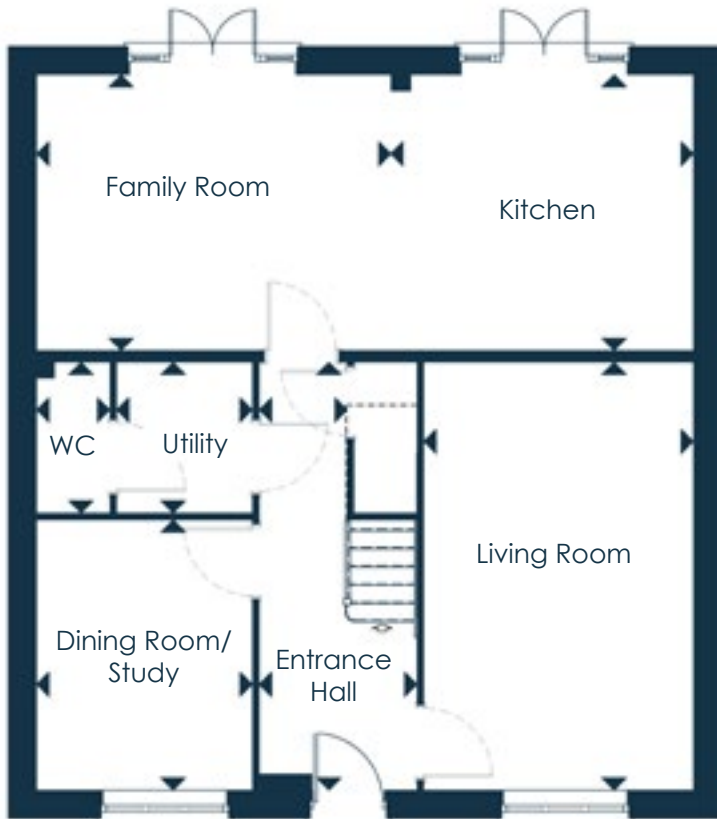

Ground Floor

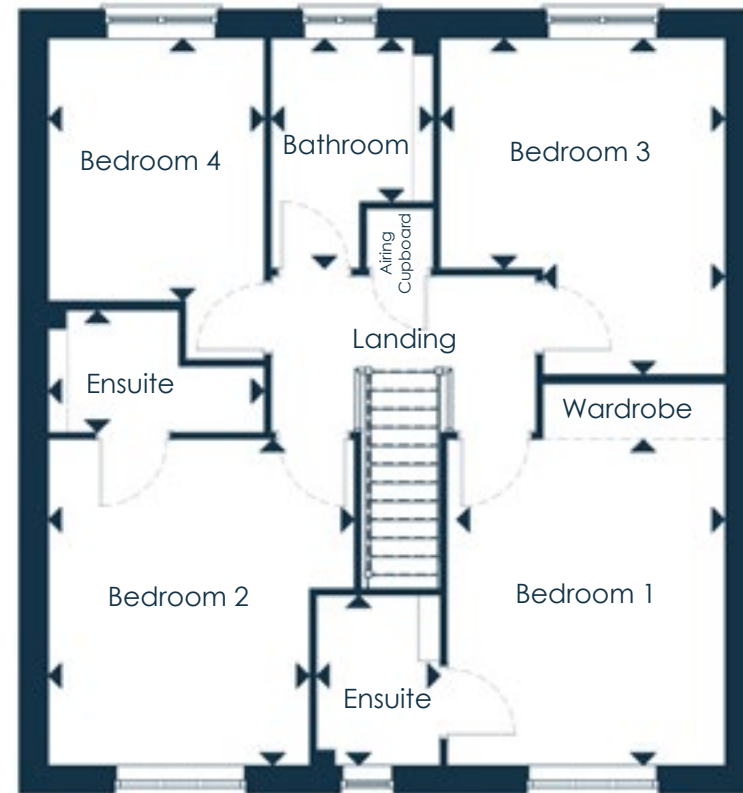

First Floor

Overall area 143.62sq.m/1546sq.ft