

The Cotford

Plot 10

Ground Floor

Entrance Hall	1.63m(2.01m*) x 3.25m	5'4"(6'7"*) x 10'8"
Kitchen/Dining Room	2.83m(3.58m*) x 6.09m	9'3"(11'9"*) x 19'11"
Utility Room	2.01m x 1.43m	6'7" x 4'8"
Living Room	3.46m x 6.09m	11'4" x 19'11"
Cloakroom	1.05m x 1.62m	3'5" x 5'3"

*Maximum dimensions supplied in irregular shaped rooms

First Floor

Bedroom 1	3.52m x 2.8m	11'6" x 9'2"
Ensuite	1.98m x 1.43m	6'6" x 4'8"
Bedroom 2	3.64m x 2.99m	11'11" x 9'9"
Bedroom 3	2.56m(3.05m*) x 3.02m	8'4"(10'0"*) x 9'10"
Bedroom 4	2.45m(3.18m*) x 2.6m	8'0"(10'5"*) x 8'6"
Bathroom	1.95m x 1.92m	6'4" x 6'3"

Please note that these floor plans show approximate dimensions only. Dimensions may vary as each property is built individually and precise internal finishes may vary during the course of construction. External finishes will vary from plot to plot. Please refer to our full disclaimer on the directions page of our brochure.

External finishes, materials, landscaping, positions of car port may also vary. Properties can also be constructed as mirror images of that shown. Please ask if you require further details or clarification.

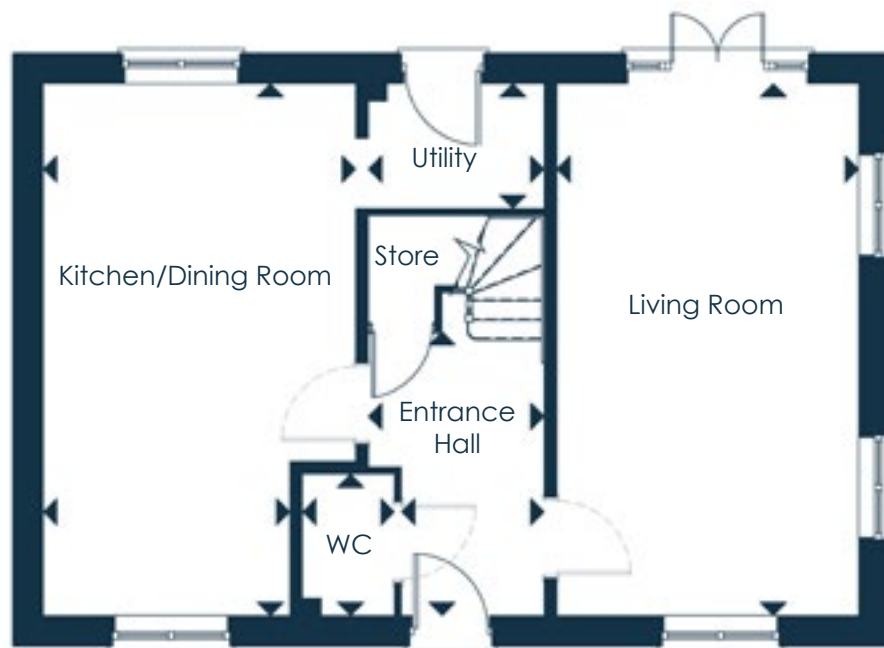

Ground Floor

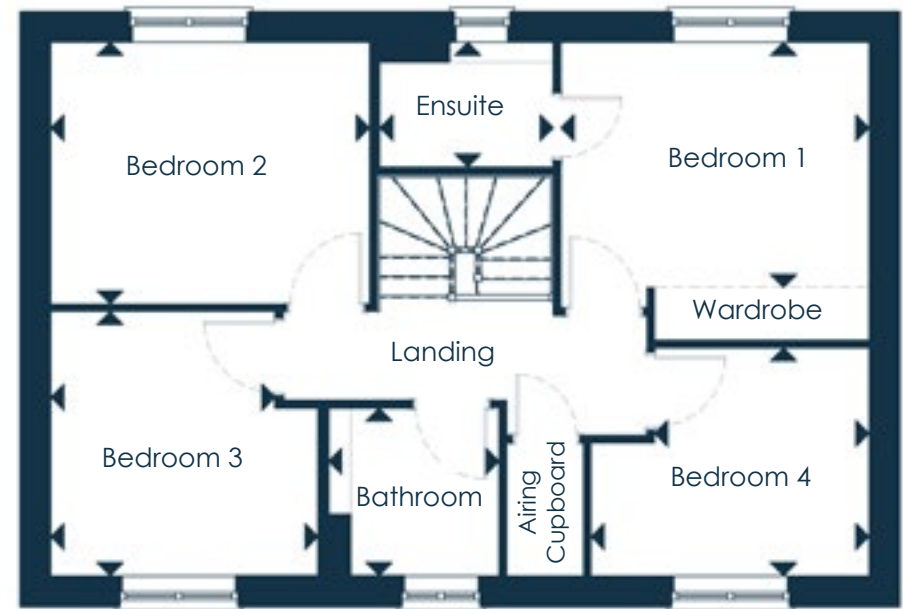

First Floor

Overall area 113.89sq.m/1226sq.ft